

NOTES

- This drawing is provisional only and should not be used for construction - **FOR PRICING AND COMMENTS ONLY**
- Formation level to be advised, currently based on as existing site level
- Presence of incompatible or differing surface will result in reflected cracking showing through any new surface
- Existing concrete slabs to be broken out and sub-structure ground to be inspected for integrity and suitability for formation over.
- Any obstructions to be recorded and broken out following confirmation from Client. Break out and seal off any exposed drain ends. Remove any exposed contaminated earth or hazardous material in accordance with current regulations
- Hardcore fill to be granular material, free from any harmful matter and excessive dust or clay, well graded not exceeding 75mm in size. Filling to be carried out in layers not exceeding 150mm. Thoroughly compact each layer
- No services have been allowed for - Any requirement from client to be cleared by Coleman & Co manager prior to proceeding
- Existing Carpark surface to be isolated using proprietary floor saw for a clean and seven cut line. Contractor to ensure all adequate controls are employed to ensure safe working and protection to others.
- Coated Macadam surface to car park as follows:
Materials and workmanship to BS4987-1 & 2
Granular sub-base min 200mm thick, compacted
Binder course 60mm thick - 20mm recipe, dense base mixture (DBM)125, compacted
Surface course 40mm thick: Stone Mastic Asphalt
- New kerbs to be 150x305x915 precast concrete - or approved alternative - to match existing. Kerbs to be have min 150mm concrete surround - refer to detail
- Road marking to Specialist Contractors recommendations: To be thermoplastic: White to parking bays, Yellow to road markings
- Wall adjacent to Northern access to be carefully taken down and rebuilt using reclaimed brick to match as far as practically possible existing.
- Existing tree to be felled to within 1.0m by Specialist contractor. Remaining trunk and remaining roots to be cleared by excavating the area.
- The area of any excavation, saw cut or other intrusive ground works to be checked with Cable Avoidance Tool prior to commencing any works. Report immediately to Coleman & Company Site management if any services are located and do not continue work until area is confirmed as cleared.

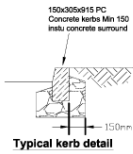

Typical kerb detail

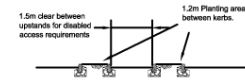

Section 1 - 1

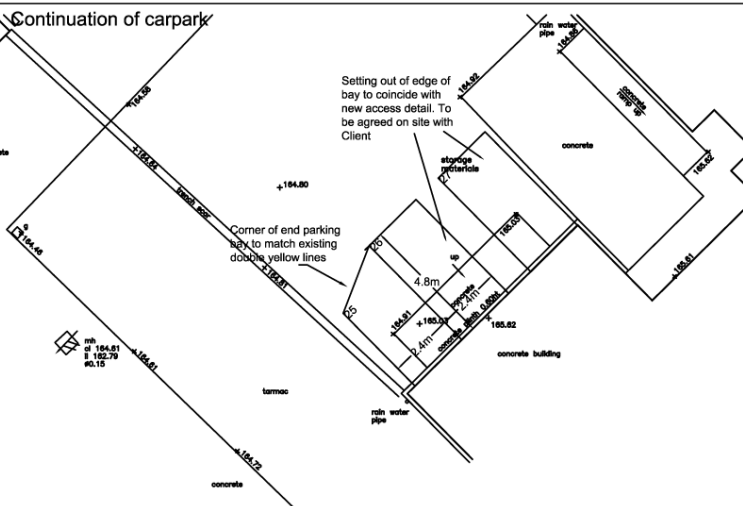
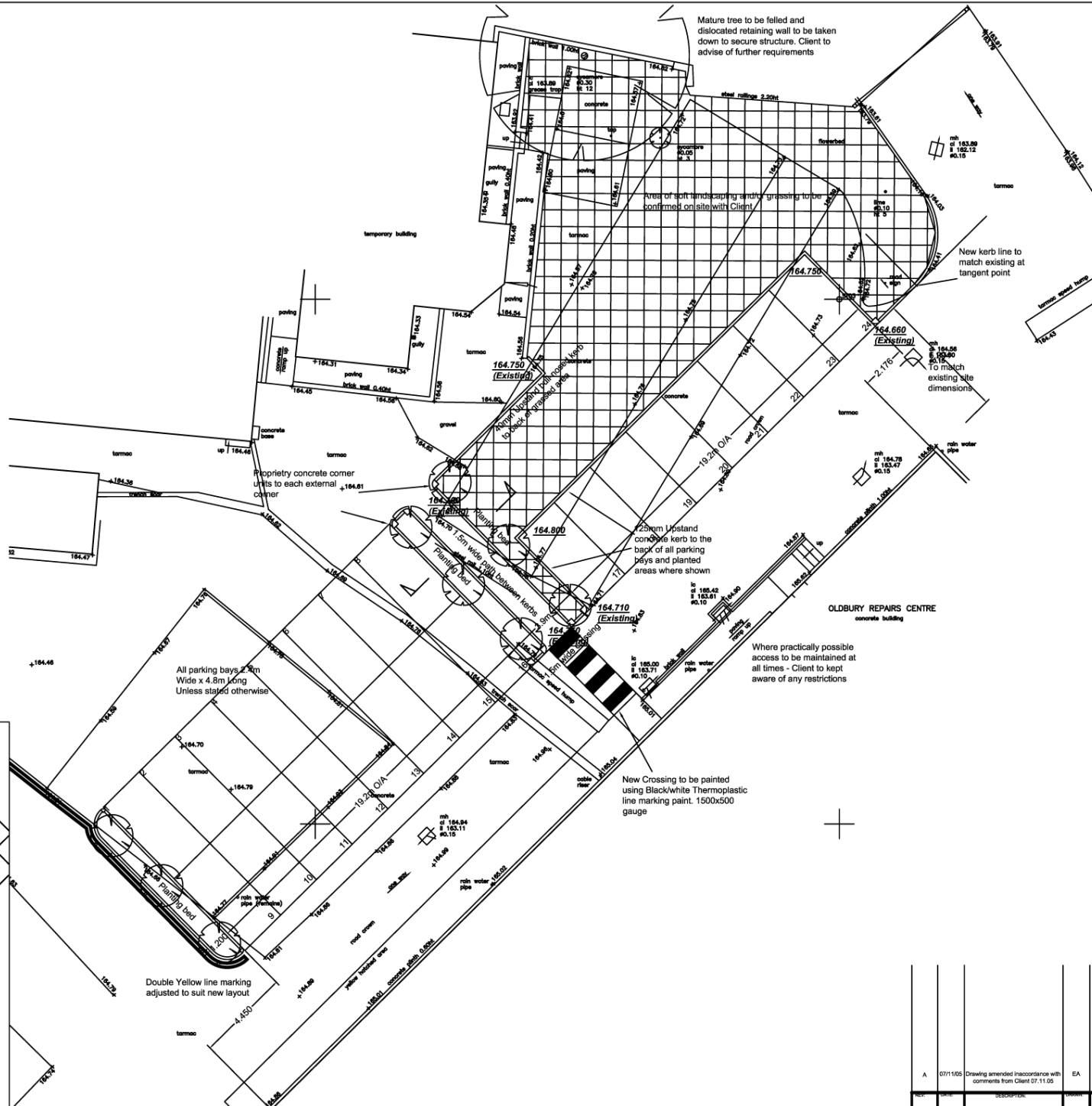

**Sandwell Depot
NEW CAR PARK LAYOUT**

THIS DRAWING IS COMMERCIALY CONFIDENTIAL AND COPYRIGHT REMAINS WITH COLEMAN & COMPANY LIMITED. THE DRAWING MAY NOT BE REPRODUCED OR USED BY OUTSIDE PARTIES WITHOUT PRIOR WRITTEN CONSENT OF COLEMAN & COMPANY LIMITED.

DATE:	3rd November 2005	1	EWA	DRG	DRG
DRAWING NUMBER:	1:100 @ A1 DRG No: C048.18/001 - P				

A	0711505	Drawing amended in accordance with comments from Client 07.11.05	EA
REP	DATE	DESCRIPTION	BY

COLEMAN & COMPANY
1865-0166 Land Reclamation Bulk Earthworks
Denomition - Land Reclamation - Bulk Earthworks

Coleman & Company Limited, Shady Lane, Great Barr, Birmingham, B44 9ER
Tel: +44(0)121-325-2424 Fax: +44(0)121-325-2425
www.coleman-co.com sales@coleman-co.com
Registered No. 731922 England. Director: DJ Coleman, MA Coleman